

OPEN

To be sure your umbrella opens smoothly, you will need to “fluff” your umbrella. While your umbrella is closed, the ribs will rest close to a 90° degree angle. Slightly open the canopy from the ends of the ribs by hand before cranking open.

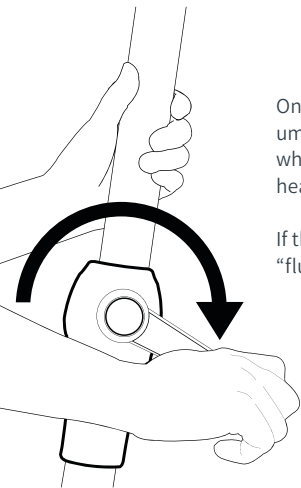

Once you begin to crank clockwise to open your umbrella, there should only be slight tension while the umbrella opens. This is due to the heavy 9 oz. Marine Grade Fabric.

If there's excessive resistance, halt cranking, and “fluff” again.

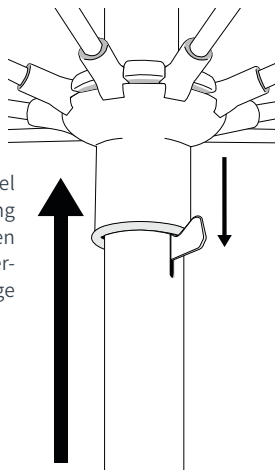

Continue to crank clockwise until the steel ledge of the EZ-Up Spring emerges. Continuing cranking past the steel ledge about an inch, then back the runner down by cranking counter-clockwise so it is resting on the steel ledge



FRANKFORD
exceptional shade

CLOSE

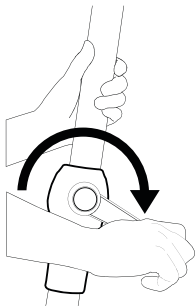

To close your umbrella, begin cranking clockwise until the runner passes the length of the EZ-Up Spring. Once you have cleared the length of the spring, the steel ledge will retract inside of the pole as the you begin to crank counter-clockwise.

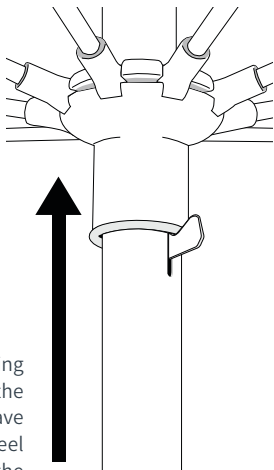

Continue cranking counter-clockwise until the umbrella is closed.

DO NOT CONTINUE CRANK BEYOND THE CLOSURE OF THE UMBRELLA.

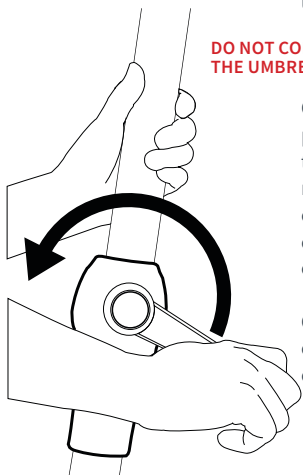

Once the umbrella is fully closed, pull any fabric that is folded between the ribs outwards. If there is visible moisture or dirt, shake dry or brush off. Storing your umbrella in such condition could cause mildew, mold or let dirt stain.

Once the umbrella is dry and visually clean, roll your umbrella up (panel over panel).